

ECG Settings: Changing QTcB display preferences

Quick Reference Guide



The QTcB formula used by ECG machines is the preferred formula for Queensland Health facilities. There can be inconsistencies in the iEMR, the following recommendations are to ensure consistency

- ECG machines should be configured to display QTcB and this should be the value on the ECG printout
- The other ECG values displayed within iEMR, including QT interval, should be unaffected and display accurate values
- If using a QT nomogram to assess risk of Torsades de Pointes, the HR and QT values obtained off an ECG within iEMR should remain accurate



It is recommended that clinicians modify their ECG display preferences to ensure are always seeing the correct values.

1. Click on the 'Cardiovascular' button on the main toolbar:

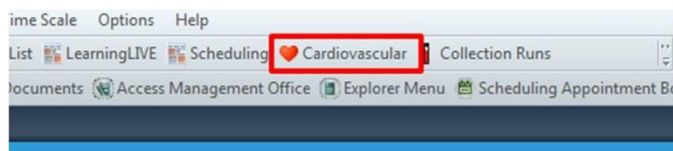

2. From the menu bar, select 'Cardiovascular' and 'Preferences'

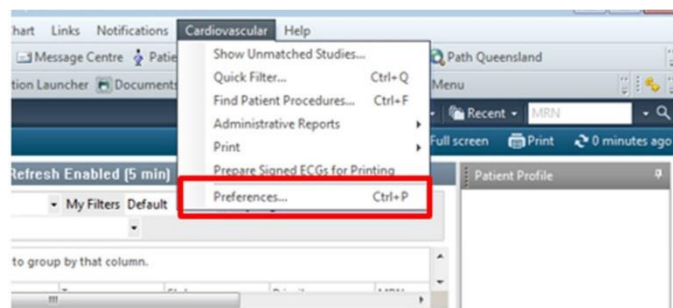

3. Select 'PowerChart ECG' from the left menu



It is recommended that "Enable Auto Compare to Previous" is **disabled** as this has limited usefulness and contributes to alert fatigue

4. "Show QTcB" should be ticked. Some clinicians may also desire "Show QTcF", this option can be selected also.
5. Apply the changes.

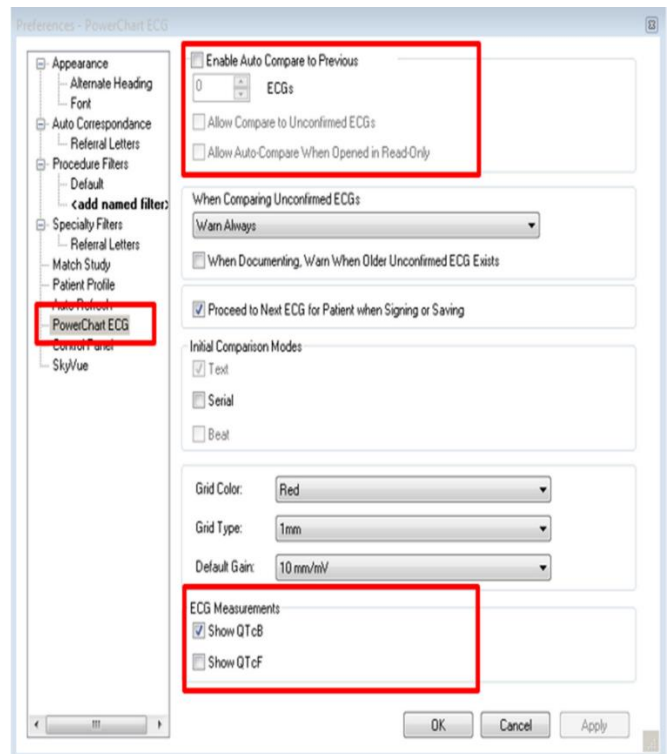

6. Once these changes are made, ECGs should display an additional field displaying the QTcB that most clinicians are familiar with. This should be accurate and align with the QTc value provided by ECG machines.

| Vent rate | 92 | BPM | <table border="1"> <thead> <tr> <th>Interpretation</th> <th>History</th> </tr> </thead> <tbody> <tr> <td colspan="2">Sinus rhythm...normal P axis, V</td> </tr> <tr> <td colspan="2">Ventricular trigeminy...trigemir</td> </tr> <tr> <td colspan="2">Borderline T abnormalities, inf</td> </tr> </tbody> </table> | Interpretation | History | Sinus rhythm...normal P axis, V | | Ventricular trigeminy...trigemir | | Borderline T abnormalities, inf | |
|----------------------------------|---------|-----|--|----------------|---------|---------------------------------|--|----------------------------------|--|---------------------------------|--|
| Interpretation | History | | | | | | | | | | |
| Sinus rhythm...normal P axis, V | | | | | | | | | | | |
| Ventricular trigeminy...trigemir | | | | | | | | | | | |
| Borderline T abnormalities, inf | | | | | | | | | | | |
| PR int | 134 | ms | | | | | | | | | |
| QRS dur | 88 | ms | | | | | | | | | |
| QT/QTc | 386 | 435 | | ms | | | | | | | |
| P-R-T axes | 8 | -9 | | -4 | | | | | | | |
| Avg RR | 656 | ms | | | | | | | | | |
| QTcB | 476 | ms | | | | | | | | | |